

Green Pin U Tipi Mapa Kilit Kare Vidalı

Green Pin Dee Shackles with Square Headed Screw Pin

• **Malzeme / Material**

Gövde ve pim yüksek mukavemetli kalite sınıfı 6 çelikten dövme imal edilmiştir

Bow and pin high tensile steel, Grade 6, quenched and tempered

• **Emniyet Katsayısı / Safety Factor**

Emniyet katsayısı 6:1'dir / MBL equals 6 x WLL

• **Standart / Standard**

EN 13889, US Fed.Spec.RR-C-271 tip IV A Class 2, Grade A ve ASME B30.26 standartlarına uygundur / EN 13889 and meets performance requirements of US Fed. Spec. RR-C-271

Type IVA Class 2, Grade A from 2 t and upward these shackles comply with ASME B30.26

Sıcak daldırma galvaniz / Hot dipped galvanize

2.1 2.2 3.1 MTC^a CE

Taşıma Kapasitesi	Gövde Çapı	Pim Çapı	Göz Çapı	Göz Kalınlığı	Ağız Açıklığı	İç Uzunluk	Dış Boy	Pim Uzunluğu	Pim Kalınlığı	Birim Ağırlık
WLL	Diameter Bow	Diameter Pin	Diameter Eye	Width Eye	Width Inside	Length Inside	Length	Length Bolt	Width Bolt Head	Weight Each
t	mm	mm	mm	mm	mm	mm	mm	mm	mm	Ad/kg
2	13,5	16	34	13	22	43	81	57,5	22	0,32
3,25	16	19	40	16	27	51	97	71	27	0,58
4,75	19	22	46	19	31	59	112	82	32	0,92
6,5	22	25	52	22	36	73	134	93	32	1,33
8,5	25	28	59	25	43	85	154	108	36	2,03
9,5	28	32	66	28	47	90	167	120	41	2,88
12	32	35	72	32	51	94	180	137	50	3,96
13,5	35	38	80	35	57	115	209	149	50	5,24
17	38	42	88	38	60	127	230	164	60	6,8
25	45	50	103	45	74	149	271	192	60	11,22

G-4154

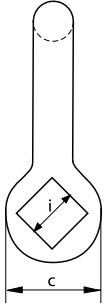
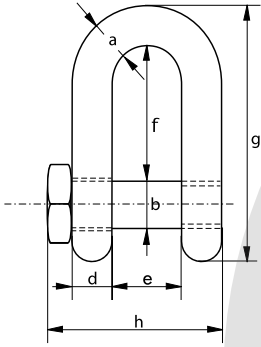

Taşıma Kapasitesi	Gövde Çapı	Pim Çapı	Göz Çapı	Göz Kalınlığı	Ağız Açıklığı	İç Uzunluk	Dış Boy	Pim Uzunluğu	Pim Kalınlığı	Birim Ağırlık
WLL	Diameter Bow	Diameter Pin	Diameter Eye	Width Eye	Width Inside	Length Inside	Length	Length Bolt	Width Bolt Head	Weight Each
t	inch	inch	inch	inch	inch	inch	inch	inch	inch	inch
2	1/2	5/8	1 11/32	1/2	7/8	1 11/16	3 3/16	2 1/4	7/8	0,7
3,25	5/8	3/4	1 9/16	5/8	1 1/16	2	3 13/16	2 25/32	1 1/16	1,28
4,75	3/4	7/8	1 13/16	3/4	1 7/32	2 5/16	4 13/32	3 7/32	1 1/4	2,03
6,5	7/8	1	2 1/16	7/8	1 13/32	2 7/8	5 9/32	3 21/32	1 1/4	2,93
8,5	1	1 1/8	2 5/16	31/32	1 11/16	3 11/32	6 1/16	4 1/4	1 13/32	4,48
9,5	1 1/8	1 1/4	2 19/32	1 3/32	1 27/52	3 17/32	6 9/16	4 23/32	1 3/8	6,35
12	1 1/4	1 3/8	2 27/32	1 1/4	2	3 11/16	7 3/32	5 13/32	1 31/32	8,72
13,5	1 3/8	1 1/2	3 5/32	1 3/8	2 1/4	4 17/32	8 7/32	5 7/8	1 31/32	11,56
17	1 1/2	1 5/8	3 15/32	1 1/2	2 3/8	5	9 1/16	6 15/32	2 3/8	15
25	1 3/4	2	4 1/16	1 25/32	2 29/32	5 7/8	10 21/32	7 9/16	2 3/8	24,74